

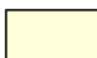











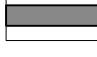

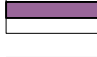
Legende

-  wassergebunden Wegedecke
-  Natursteinplatten 40/60 (Mähstreifen)
-  Natursteinplatten 40 x 40
-  Kies-/Splittfläche
-  Asphalt - Bestand
-  Stellstufen Granit
-  Granit-Großpflaster 1-zeilig / 2-zeilig
-  Stützmauer, Naturstein mit Abdeckplatte
-  Rasen
-  Blumen / Stauden
-  Bodendecker (Luzula sylv. 12 St./m²)
-  Grabstellen
-  Baum - Bestand (Laub-/Nadelbaum)
-  Baum / Strauch - Neupflanzung
-  Gedenkstein / Grabmal

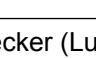
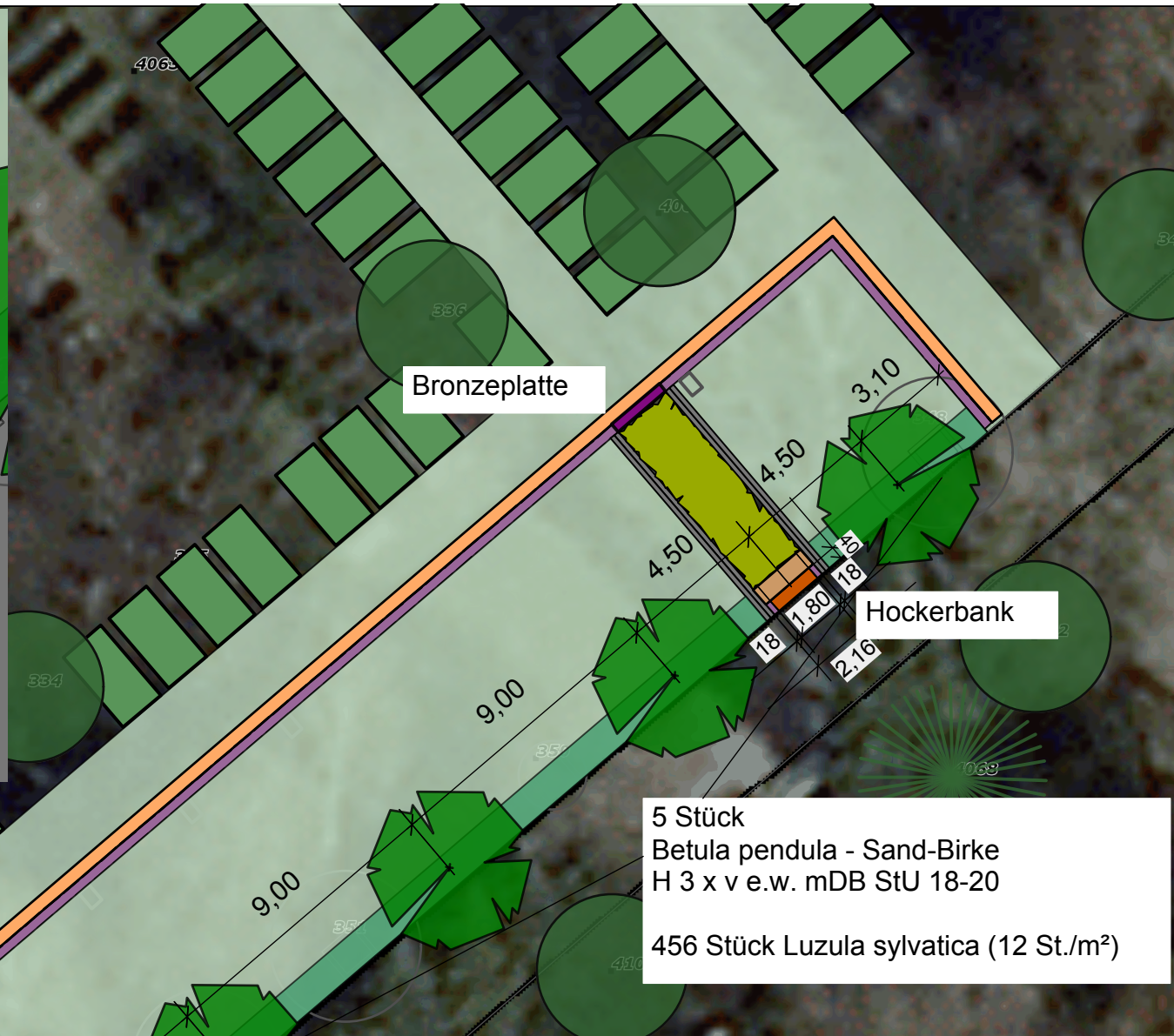
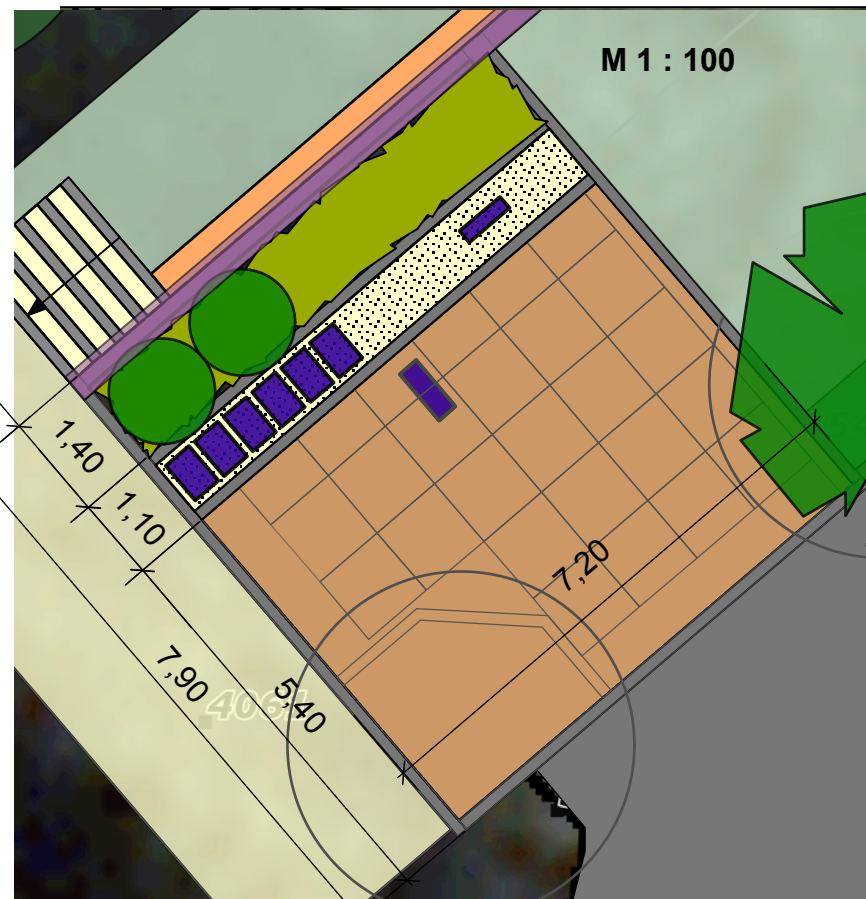

2 Stück
Taxus baccata - Gewöhnliche Eibe
Sol 4 x v mDB B 60-80 H 100-125

5 Stück
Betula pendula - Sand-Birke
H 3 x v e.w. mDB StU 18-20
456 Stück Luzula sylvatica (12 St./m²)

a	09.04.2015	Ergänzung Bodendecker (Luzula sylv.)
INDEX	DATUM	ÄNDERUNG



HANSESTADT ROSTOCK

Amt für Stadtgrün, Naturschutz
und Landschaftspflege

Neuer Friedhof Sanierung / Neugestaltung der Gedenkstätte der Opfer faschistischer Gewaltherrschaft

Maßstab 1 : 200/100	Datum: Februar 2015	Blatt-Nr.: 02 - Entwurf	Zeichner: FC
------------------------	------------------------	----------------------------	-----------------

Bearbeiter:	geprüft:
-------------	----------